

Single Ply warm roof adhered with VIP insulation

BauderTHERMOPLAN FPO Single Ply System

Adhered, warm roof, single ply membrane waterproofing system suitable for new build, refurbishment and extensive green roof applications.



	Function	Product name	Thickness (mm)	Weight (kg/m ²)
1	Waterproofing	BauderTHERMOPLAN T 15 V	3.5	2.1
2	Insulation & membrane attachment method	Adhered	Nominal	Nominal
3	Insulation (0.13)	BauderVIP TE Flatboard*	80	17
4	Air and vapour control layer (AVCL)	BauderTEC KSD FBS	2.5	2.5
System Build-up			86.0	21.6
In-depth and up-to-date product specific technical data is available for each element within a system. Download from our website bauder.co.uk/technical-centre				

Warm roof indicative build-up

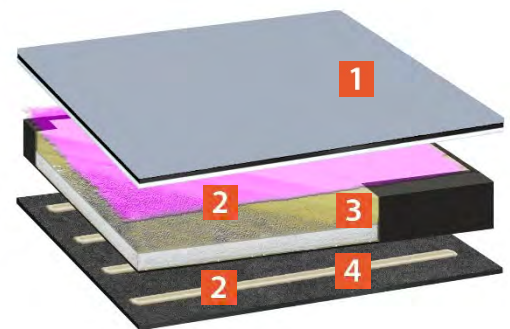

*VIP TE Insulation based on 80mm VIP TE with PIR FA-TE at infills and perimeters utilising 80% VIP TE and 20% FA-TE to achieve approximately 0.13 U Value. A project specific VIP TE design would be required to confirm exact U Value achieved.

Characteristics of the system

- Flame free installation using hot air welding
- Light weight membrane, typically 2-3kg/m²
- High performance halogen-free fire retardant
- Approved for green roof landscaping by FLL
- Comprehensive guarantee packages to meet project requirements

System summary



Accreditations and approvals



System variations are available to the specifier so that a tailored solution meets the needs of the building. The selection of products should be confirmed with our technical department to ensure suitability for the individual construction requirements of the flat roof.

E: technical@bauder.co.uk

T: 01473 257671

OPTIONS AVAILABLE

In-depth and up-to-date product specific technical data is available for each component within a system. Download from our website bauder.co.uk/technical-centre

Membrane finish colours		
	Silver Grey (RAL 7001)	Pearl White (RAL 1013)

Membrane AVCL alternatives	Thickness (mm)	Weight (kg/m ²)
BauderTEC DBR 06	0.6	0.7
BauderTEC KSD Foil	1.5	1.8

BauderVIP TE Flatboard Insulation thickness	Approx. 'U' VALUE (W/m ² K)	Weight (kg/m ²)
60mm**	0.18	13
80mm**	0.13	17

Approx. 'U' VALUE (W/m²K) assuming concrete or timber deck and does not take into account any materials below the deck

** Based on ratio of 80% VIP TE & 20% FA-TE. A project specific VIP TE design would be required to confirm exact U Value achieved.

System fire performance

Please contact the Bauder Technical Dept to check if the system assembly stated has an independently tested performance against fire.